



CM16938

# DOUBLE

FLOOR - PC1297



Download

### COMPONENTS INCLUDED WITH UNIT:

1× light  
2× set screw M4×6  
1× hex key size 2  
1× pair cotton gloves  
1× installation manual

### WARNING:

**The manufacturer assumes no liability for damage resulting from incorrect assembly.**

**When unpacking the light, do so with regard for its material composition – the main components are made of glass.**

**Wear the cotton gloves included with the light when unpacking and assembling it.**

**IF THE EXTERNAL FLEXIBLE CABLE OF THIS LIGHT IS DAMAGED, FOR SAFETY REASONS IT MUST ONLY BE REPLACED BY THE MANUFACTURER, A TECHNICIAN AUTHORIZED BY THE MANUFACTURER, OR A PERSON WITH THE SAME QUALIFICATIONS.**

**Installation time: 15 minutes / 1 person**



BROKIS®

BROKIS S.R.O.  
ŠPANELOVA 1315/25  
163 00 PRAHA 6 - ŘEPY  
CZECH REPUBLIC

ORG. ID 64940799  
VAT ID CZ64940799  
C 42174 MĚSTSKÝ SOUD  
V PRAZE

TEL +420 567 211 517  
TECHNICAL@BROKIS.CZ  
INFO@BROKIS.CZ  
WWW.BROKIS.CZ



### CLEANING THE GLASS

**BROKIS upholds only the highest possible quality standards. Prior to shipping, the light undergoes several quality controls and stages of cleaning. Because transportation, storage, and the amount of time that passes between packing at our plant and subsequent unpacking by the client can affect the light in different ways, we strongly recommend cleaning it prior to assembly.**

**The glass must first be rinsed in warm water, and a dish detergent may be used to remove all foreign particles, dust, and grease. Repeat the process if necessary and then dry the glass thoroughly with a paper towel.**

**Recommendation: Do not use mineral spirits, highly concentrated thinners, or other substances not intended for use on glass surfaces. Do not use any cleaning agents containing silicone, as they may leave a film and attract dust and smudges.**

**PRIOR TO SHIPPING, THE FUNCTIONALITY OF EACH LIGHT AND ITS COMPONENTS IS THOROUGHLY TESTED. THE MANUFACTURER ASSUMES NO LIABILITY FOR THE MISHANDLING OF PRODUCTS.**



## 1. ASSEMBLING THE LIGHT

Assemble the light by joining the upper and lower sections. First, use the size 2 hex key to loosen the two M4×6 set screws in the upper section. Next, snap the two halves of the connector together and slide the upper section of the light onto the lower section. Complete assembly by retightening the set screws.

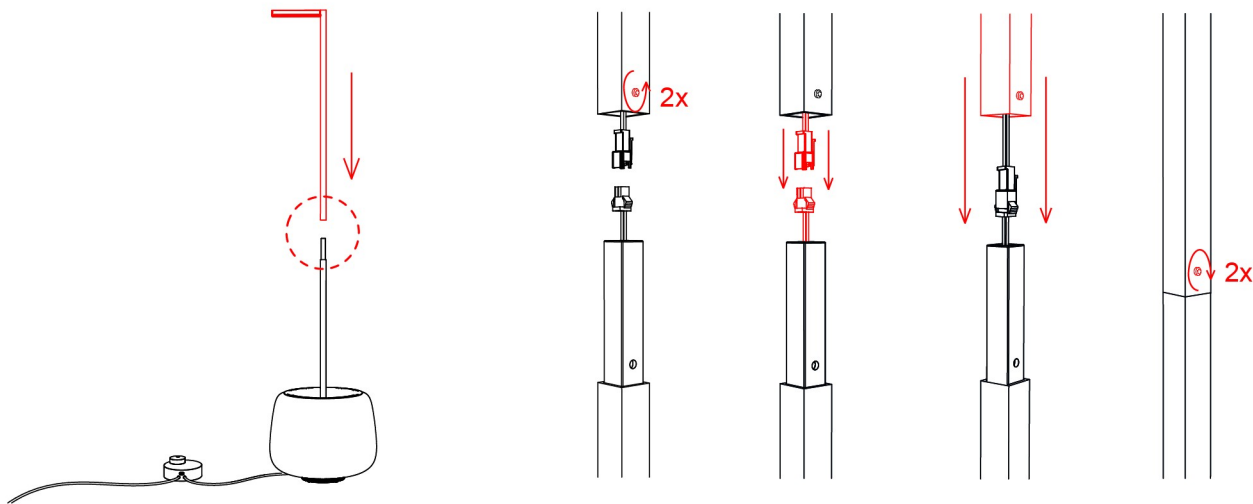

## 2. SWITCHING ON THE LIGHT

Plug the light into an electrical outlet and slide the switch to ON. Verify that the light works properly.

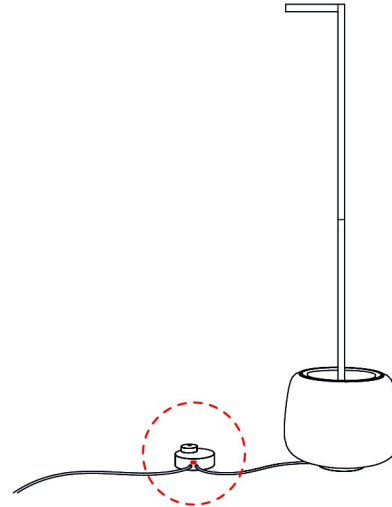
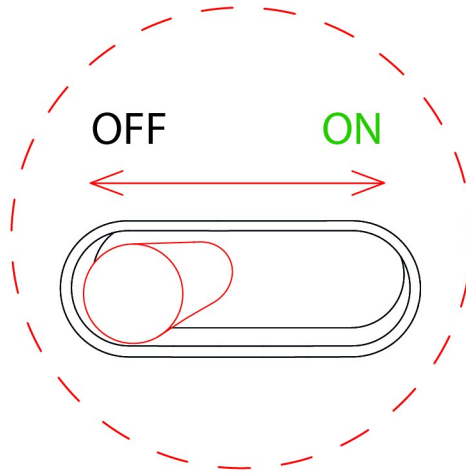

### 3. DIMMING THE LIGHT

Turn the knob to decrease or increase the intensity of the light.

Dimming is possible only when the switch is in the ON position.

